

PROJECT PLANNING APPLICATION PRELIMINARY PLANS

491 S. EL CAMINO REAL - SLEEP TRAIN

CITY OF SAN MATEO SAN MATEO COUNTY CALIFORNIA

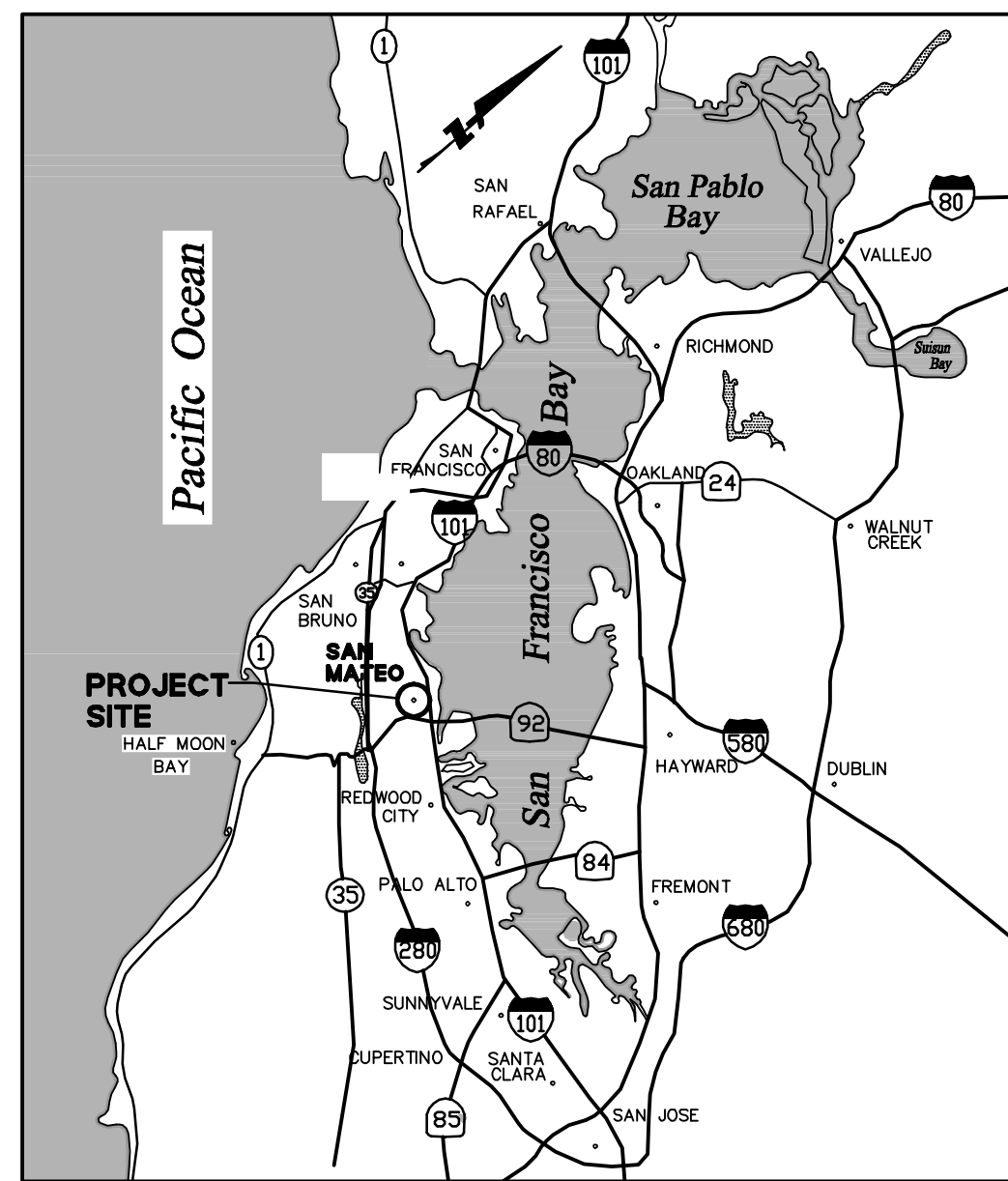

VICINITY MAP

NTS

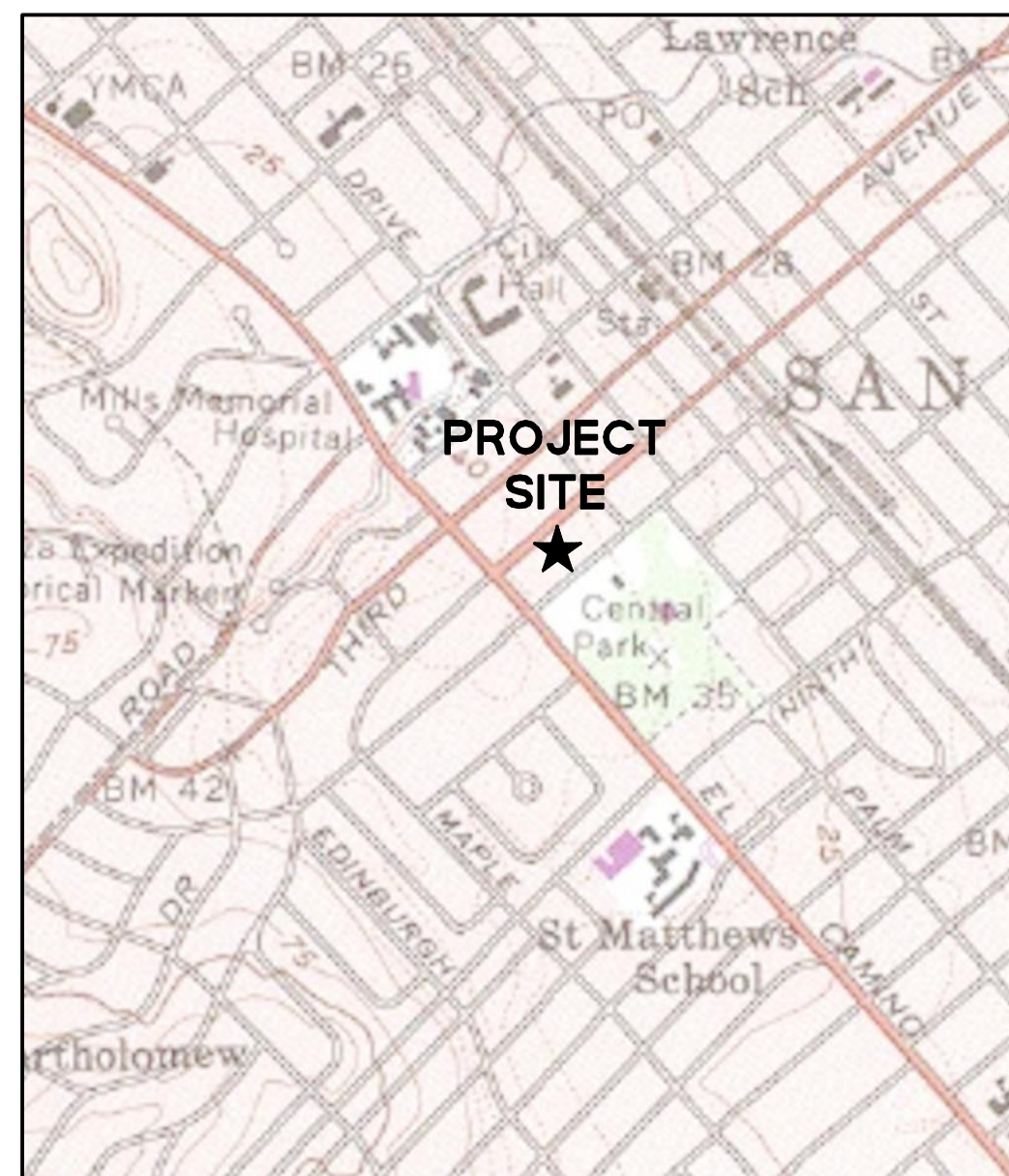

LOCATION MAP

NTS

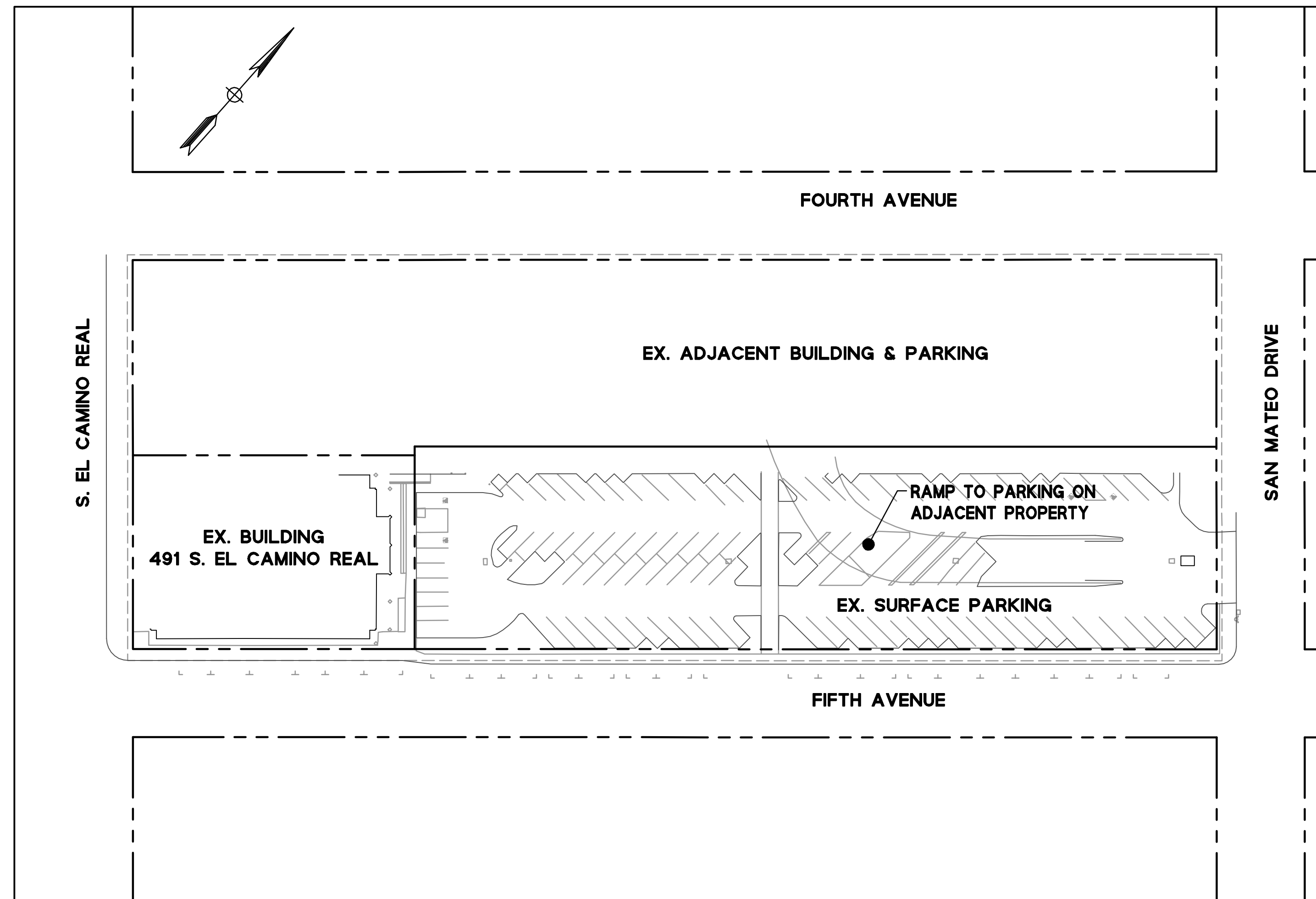

SITE PLAN

SCALE 1"=50'

SHEET INDEX

SHEET NO	DESCRIPTION
C1.00	TITLE SHEET
C2.00	EXISTING SITE PLAN
C3.00	EXISTING PARKING PLAN
C4.00	OFFSITE LOADING AREA PLAN

BASIS OF BEARINGS

THE BASIS OF BEARINGS SHOWN ON THIS MAP IS IDENTICAL TO THAT AS SHOWN ON THAT CERTAIN MAP ENTITLED "PARCEL MAP NO. 400 FOR CENTRAL PARK PLAZA", FILED FOR RECORD ON JUNE 18, 2004 IN VOLUME 75 OF PARCEL MAPS AT PAGES 53 & 54, SAN MATEO COUNTY RECORDS.

BENCHMARK

ELEVATIONS AS SHOWN HEREON ARE BASED ON A FOUND RAMSET NAIL AND WASHER AT THE TOP OF CURB OVER CB S'LY SIDE OF 5TH AVENUE AT SAN MATEO DRIVE AS FOLLOWS:

BENCHMARK#: 033-006
 DATUM: SAN MATEO
 ELEVATION: 31.432

ENGINEER'S STATEMENT

THESE PROJECT PLANNING APPLICATION PRELIMINARY PLANS, SHEETS C1.00 THROUGH C5.00, HAVE BEEN PREPARED BY ME OR UNDER MY DIRECTION IN ACCORDANCE WITH STANDARD ENGINEERING PRACTICE.

ROLAND N.V. HAGA, P.E. DATE
 BKF ENGINEERS
 ASSOCIATE/PROJECT MANAGER
 R.C.E. NO. 43971



Project Engineer	Date	Senior Engineer	Date	Deputy Director	Date	REVISION NO.	DESCRIPTION	BY	DATE
491 S. EL CAMINO REAL - SLEEP TRAIN PROJECT PLANNING APPLICATION TITLE SHEET									
BKF ENGINEERS & ARCHITECTS / PLANNERS 205 S. BASCOM AVE. SUITE 200 REDWOOD CITY, CA 94065 650-482-6300 (PHONE) 650-482-6399 (FAX) BKF PROJECT NO. 20110212									
BOOK NO.	DESIGNED BY: MD	DATE:	DRAWN BY: MD	DATE:	APPROVED BY: RH	DATE:	SCALE: AS SHOWN	PROJECT NO.:	-
CASE	DRAWER	SET							
-	-	-							
SHEET 1 OF 4									

DRAWING NAME: 491 S. EL CAMINO REAL PROJECT PLANNING APPLICATION PRELIMINARY PLANS SHEETS C1.00 THROUGH C5.00
 PLOT TIME: 04-20-12 2:03pm